

METRIC PORT CONTOUR CUTTER INTERNAL STRAIGHT THREAD O-RING BOSS

CARBIDE TIPPED
STRAIGHT SHANK
W/ID GROOVE

ISO 6149-1, SAE J2244 WITH ID GROOVE



Reamer pilot series porting tools profile the ISO 6149-1 contour and ID groove. The reamer also sizes the minor diameter per class 6H thread specification. Cutters are heat treated for toughness and durability all tolerances are held within applicable ISO Specs. All grinding is done between centers to insure concentricity.

COATINGS AVAILABLE
TITANIUM NITRIDE-TIN
TITANIUM CARBONITRIDE-TICN
TITANIUM ALUMINUM NITRIDE-TIALN
AL TITANIUM NITRIDE-ALTN

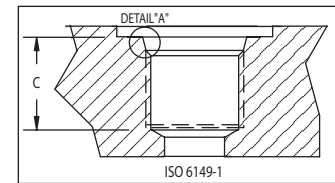
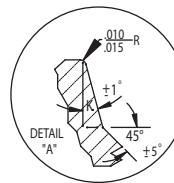
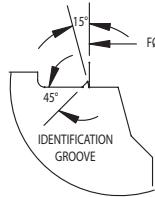
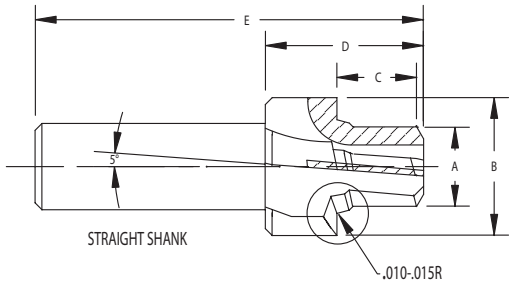

COOLANT THRU AVAILABLE

TOOL NUMBER	THREAD SIZE	A REAMER DIA.	B SPOTFACE DIA.	C REAMER LENGTH	D HEAD LENGTH	E OAL LENGTH	F RIDGE DIA.	SHANK DIMENSIONS		K ANGLE	NO. OF FLUTES
								SHANK DIA.	SHANK LENGTH		
M1-08TG	M 8X1	.277	.669	.453	1-1/8	3-1/8	.551	.500	2	12	3
M1-10TG	M 10X1	.356	.787	.453	1-1/4	3-1/4	.630	.500	2	12	3
M1-12TG	M 12X1.5	.415	.906	.551	1-1/4	3-1/4	.748	.500	2	15	3
M1-14TG	M 14X1.5	.493	.984	.551	1-1/4	3-1/4	.826	.500	2	15	3
M1-16TG	M 16X1.5	.572	1.102	.610	1-1/4	3-1/4	.945	.500	2	15	3
M1-18TG	M 18X1.5	.651	1.181	.669	1-3/8	3-3/8	1.024	.750	2	15	3
M1-20TG	M 20X1.5	.730	1.260	.689	1-3/8	3-3/8	1.063	.750	2	15	3
M1-22TG	M 22X1.5	.808	1.339	.709	1-5/8	3-5/8	1.142	.750	2	15	3
M1-27TG	M 27X2	.985	1.575	.866	1-7/8	4-1/8	1.338	.750	2-1/4	15	3
M1-33TG	M 33X2	1.221	1.929	.866	1-7/8	4-1/8	1.693	.750	2-1/4	15	3
M1-42TG	M 42X2	1.576	2.362	.886	1-7/8	4-1/8	2.047	1.000	2-1/4	15	3
M1-48TG	M 48X2	1.812	2.598	.984	2	4-1/4	2.244	1.000	2-1/4	15	4
M1-60TG	M 60X2	2.284	2.992	1.083	2	4-1/4	2.638	1.000	2-1/4	15	4



FORM RELIEF TOOL CO., INC.
www.formrelief.com

14499 ROUTE 72 EAST
 DAVIS JUNCTION, IL 61020
 (815) 393-4263 • FAX (815) 393-3143