

ROLL THREADING PORT CUTTERS SAE PORT CONTOUR CUTTERS FOR ROLL THREADS INTERNAL STRAIGHT THREAD O-RING BOSS

CARBIDE TIPPED
STRAIGHT SHANK

MS16142 / J514 / J1926



Reamer pilot series porting tools profiles the MS16142 / J514F / J1926 contour. The reamer pilot also sizes the minor diameter for one of three thread percentages 75%, 65% and 55% depending on the thread percentage equired. Cutters are heat treated for toughness and durability. All tolerances are held within applicable Mil Specs. All grinding is done between centers to insure concentricity.

COATINGS AVAILABLE

TITANIUM NITRIDE-TIN
TITANIUM CARBONITRIDE-TICN
TITANIUM ALUMINUM NITRIDE-TIALN
AL TITANIUM NITRIDE-ALTN

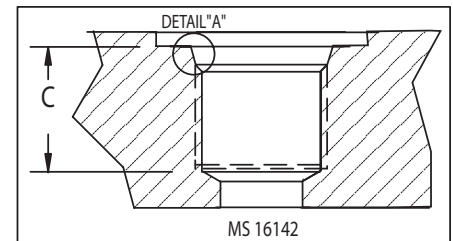
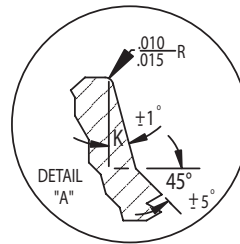
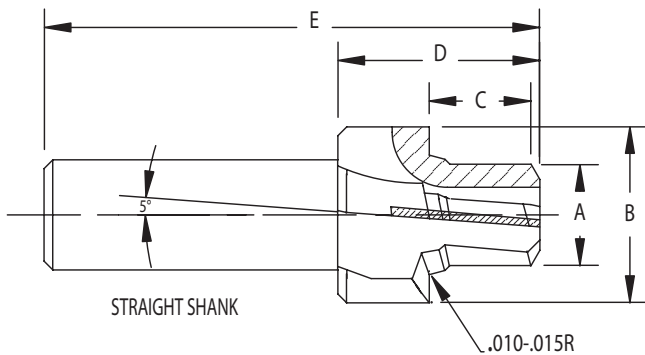

COOLANT THRU AVAILABLE • All diameters and dimensions can be altered to meet your requirements

TOOL NUMBER	TUBE NO.	TUBE SIZE	THREAD SIZE	REAMER DIA. REQ'D FOR			B SPOTFACE DIA.	C REAMER LENGTH	D HEAD LENGTH	E OAL LENGTH	SHANK DIMENSIONS	
				75% THREAD	65% THREAD	55% THREAD					SHANK DIA.	SHANK LENGTH
SAE-02T	2	1/8	5/16-24	.292	.294	.297	.682	.473	1-1/8	3-1/8	.500	2
SAE-03T	3	3/16	3/8-24	.355	.356	.359	.760	.473	1-1/4	3-1/4	.500	2
SAE-04T	4	1/4	7-16-20	.414	.416	.418	.838	.552	1-1/4	3-1/4	.500	2
SAE-05T	5	5/16	1/2-20	.475	.477	.480	.916	.552	1-1/4	3-1/4	.500	2
SAE-06T	6	3/8	9/16-18	.536	.537	.540	.979	.614	1-1/4	3-1/4	.500	2
SAE-08T	8	1/2	3/4-16	.720	.723	.726	1.198	.693	1-3/8	3-3/8	.750	2
SAE-10T	10	5/8	7/8-14	.839	.843	.845	1.354	.786	1-5/8	3-5/8	.750	2

